

JVC



COMPACT COMPONENT SYSTEM

NX-PS1

—Consists of CA-NXPS1, SP-NXPS1F and SP-NXPS1W

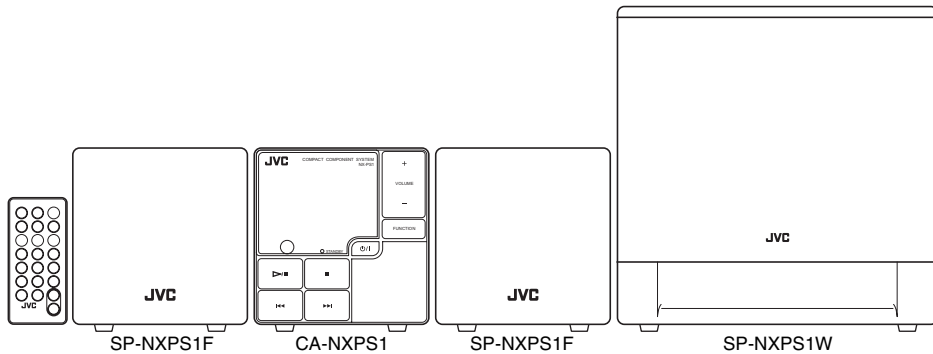

MP3/WMA
PLAYBACK



INSTRUCTIONS

For Customer Use:

Enter below the Model No. and Serial No. which are located either on the rear, bottom or side of the cabinet. Retain this information for future reference.

Model No. _____

Serial No. _____

LVT1633-001B

[J]

Warnings, Cautions and Others Mises en garde, précautions et indications diverses

(For U.S.A.)



The lightning flash with arrowhead symbol, within an equilateral triangle is intended to alert the user to the presence of uninsulated "dangerous voltage" within the product's enclosure that may be of sufficient magnitude to constitute a risk of electric shock to persons.



The exclamation point within an equilateral triangle is intended to alert the user to the presence of important operating and maintenance (servicing) instructions in the literature accompanying the appliance.

(For U.S.A.)

WARNING: TO REDUCE THE RISK OF FIRE OR ELECTRIC SHOCK, DO NOT EXPOSE THIS APPLIANCE TO RAIN OR MOISTURE.

CAUTION

To reduce the risk of electrical shocks, fire, etc.:

- 1 Do not remove screws, covers or cabinet.
- 2 Do not expose this appliance to rain or moisture.

ATTENTION

Afin d'éviter tout risque d'électrocution, d'incendie, etc.:

- 1 Ne pas enlever les vis ni les panneaux et ne pas ouvrir le coffret de l'appareil.
- 2 Ne pas exposer l'appareil à la pluie ni à l'humidité.

CAUTION— ⏻/I (STANDBY/ON) button!

Disconnect the mains plug to shut the power off completely (all lamps and indications go off). When installing the product ensure that the plug is easily accessible. The ⏻/I button in any position does not disconnect the mains line.

- When the unit is on standby, the STANDBY lamp lights in red.
- When the unit is turned on, the STANDBY lamp goes off.

The power can be remote controlled.

ATTENTION—Touche ⏻/I (STANDBY/ON)!

Deconnectez la fiche secteur pour mettre l'appareil complètement hors tension (tous les témoins et toutes les indications s'éteignent). Lors de l'installation de l'appareil, assurez-vous que la fiche soit facilement accessible. La touche ⏻/I dans n'importe quelle position ne deconnecte pas l'appareil du secteur.

- Quand l'appareil est en mode d'attente, le témoin STANDBY est allumé en rouge.
- Quand l'appareil est sous tension, le témoin STANDBY s'éteint.

L'alimentation ne peut pas être commandée à distance.

(For U.S.A.)

This equipment has been tested and found to comply with the limits for a Class B digital device, pursuant to part 15 of the FCC Rules. These limits are designed to provide reasonable protection against harmful interference in a residential installation.

This equipment generates, uses and can radiate radio frequency energy and, if not installed and used in accordance with the instructions, may cause harmful interference to radio communications. However, there is no guarantee that interference will not occur in a particular installation. If this equipment does cause harmful interference to radio or television reception, which can be determined by turning the equipment off and on, the user is encouraged to try to correct the interference by one or more of the following measures:

Reorient or relocate the receiving antenna.
Increase the separation between the equipment and receiver.
Connect the equipment into an outlet on a circuit different from that to which the receiver is connected.
Consult the dealer or an experienced radio/TV technician for help.

(For U.S.A.)

CAUTION

Changes or modifications not approved by JVC could void the user's authority to operate the equipment.

(For U.S.A.)

For the main unit:

Declaration of Conformity

Model Number: NX-PS1

Trade Name: JVC

Responsible Party: JVC Americas Corp.

Address: 1700 Valley Road, Wayne
New Jersey 07470

Telephone Number: 973-317-5000

This device complies with Part 15 of FCC Rules.

Operation is subject to the following two conditions:

(1) This device may not cause harmful interference, and (2) this device must accept any interference received, including interference that may cause undesired operation.

For Canada/pour le Canada

THIS DIGITAL APPARATUS DOES NOT EXCEED THE CLASS B LIMITS FOR RADIO NOISE EMISSIONS FROM DIGITAL APPARATUS AS SET OUT IN THE INTERFERENCE-CAUSING EQUIPMENT STANDARD ENTITLED "DIGITAL APPARATUS," ICES-003 OF THE DEPARTMENT OF COMMUNICATIONS.

CET APPAREIL NUMERIQUE RESPECTE LES LIMITES DE BRUITS RADIOELECTRIQUES APPLICABLES AUX APPAREILS NUMIRIQUES DE CLASSE B PRESCRITES DANS LA NORME SUR LE MATERIEL BROUILLEUR; "APPAREILS NUMERIQUES", NMB-003 EDICTEE PAR LE MINISTRE DES COMMUNICATIONS.

Caution: Proper Ventilation

To avoid risk of electric shock and fire, and to prevent damage, locate the apparatus as follows:

1. Front: No obstructions and open spacing.
2. Sides/ Top/ Back: No obstructions should be placed in the areas shown by the dimensions below.
3. Bottom: Place on the level surface. Maintain an adequate air path for ventilation by placing on a stand with a height of 10 cm ($3\frac{15}{16}$ ") or more.

Attention: Aération correcte

Pour prévenir tout risque de décharge électrique ou d'incendie et éviter toute détérioration, installez l'appareil de la manière suivante:

1. Avant: Bien dégagé de tout objet.
2. Côtés/dessus/dessous: Assurez-vous que rien ne bloque les espaces indiqués sur le schéma ci-dessous.
3. Dessous: Posez l'appareil sur une surface plane et horizontale. Veillez à ce que sa ventilation correcte puisse se faire en le plaçant sur un support d'au moins dix centimètres de hauteur.

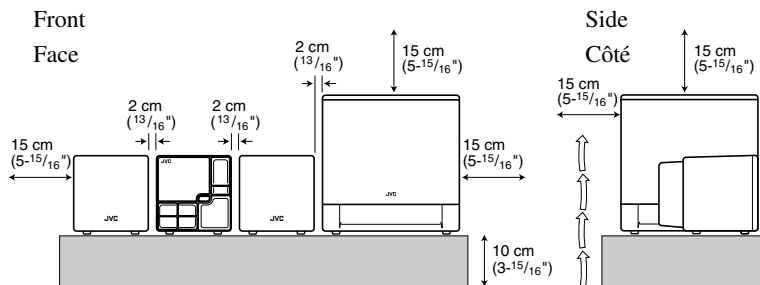

[European Union only]

[Union européenne seulement]

Contents

Introduction	2
Precautions	2
Getting Started	3
Connection	4
Basic Operations	5
Unit	5
Remote Control	6
Setting the Clock and Daily Timer	7
Setting the Clock	7
Setting the Daily Timer	7
Playing Back from iPod	8
To Connect iPod	8
Basic Operations	8
Playing Back from USB mass storage class device	9
To connect the USB mass storage class device	9
Basic Operations	9
Playing Back from the PC	10
How to install the USB drivers	10
To playback sounds on the PC	10
Playing Back from Other Equipment	11
To connect other equipment	11
Troubleshooting	11
Specifications	12

Introduction

Thank you for purchasing a JVC product.

Please read all instructions carefully before operation, to ensure your complete understanding and to obtain the best possible performance from the unit.

Precautions

● Installation

- Install in a place which is level, dry and neither too hot nor too cold—between 5°C and 35°C (41°F and 95°F).
- Install the System in a location with adequate ventilation to prevent internal heat buildup inside the System.



DO NOT install the System in a location near heat sources, or in a place subject to direct sunlight, excessive dust or vibration.

- Leave sufficient distance between the System and the TV.
- Keep the speakers away from the TV to avoid interference with TV.

● Power sources

- When unplugging the System from the wall outlet, always pull on the plug, not the AC adaptor.



DO NOT handle the AC adaptor with wet hands.

● Internal heat

For safety, observe the following carefully:

- Make sure there is good ventilation the main unit. Poor ventilation could overheat and damage the System.
- DO NOT block the ventilation openings or holes. If they are blocked by a newspaper or cloth, etc., the heat may not be able to get out.



● Others

- Should any metallic object or liquid fall into the System, unplug the AC adaptor and consult your dealer before operating any further.



DO NOT disassemble the System since there are no user serviceable parts inside.

- If you are not going to operate the System for an extended period of time, unplug the AC adaptor from the wall outlet. If anything goes wrong, unplug the AC adaptor and consult your dealer.

Getting Started

● Supplied Accessories

After unpacking, check to be sure that you have all the following items. The number in parentheses indicates the quantity of each piece supplied.

- Remote control (1)
- Lithium coin battery CR2025 (1) (The battery has been installed when shipped from the factory.)
- Speaker cords 1.5m (2)
- Speaker cord 2.5m (1)
- AC power cord (1)
- AC adaptor (AA-R2401) (1)
- iPod connection cable (Audio) (1)
- iPod stand (1)

If anything is missing, consult your dealer immediately.

CAUTION:

To avoid risk of fire, and to prevent damage.

- Do not use AC adaptors except the supplied AC adaptor.
- Do not use the supplied AC adaptor for other equipment.

● Prepare the Remote Control

When you use the remote control for the first time, pull out the insulation sheet.

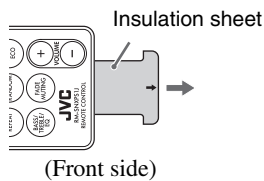

Replacing the Battery in the Remote Control

Insert the battery into the remote control by matching the polarity (+ and -) correctly.

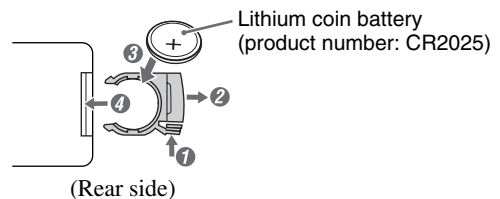

Warning

- Store the battery in a place where children cannot reach. If a child accidentally swallows the battery, consult a doctor immediately.
- Do not recharge, short, disassemble or heat the battery or dispose of it in a fire. Doing any of these things may cause the battery to give off heat, crack, or start a fire.
- Do not leave the battery with other metallic materials. Doing this may cause the battery to give off heat, crack, or start a fire.
- When throwing away or saving the battery, wrap it in tape and insulate; otherwise, the battery may start to give off heat, crack, or start a fire.
- Do not poke the battery with tweezers or similar tools. Doing this may cause the battery to give off heat, crack, or start a fire.
- Dispose of battery in the proper manner, according to federal, state, and local regulations.

For USA-California Only

This product contains a CR Coin Cell Lithium Battery which contains Perchlorate Material – special handling may apply.

See <http://www.dtsc.ca.gov/hazardouswaste/perchlorate>

CAUTION:

Danger of explosion if battery is incorrectly replaced.
Replace only with the same or equivalent type.

Connection

Do not connect the AC power cord until all other connections have been made.

To a wall outlet
Plug the AC power cord only after all connections are complete.

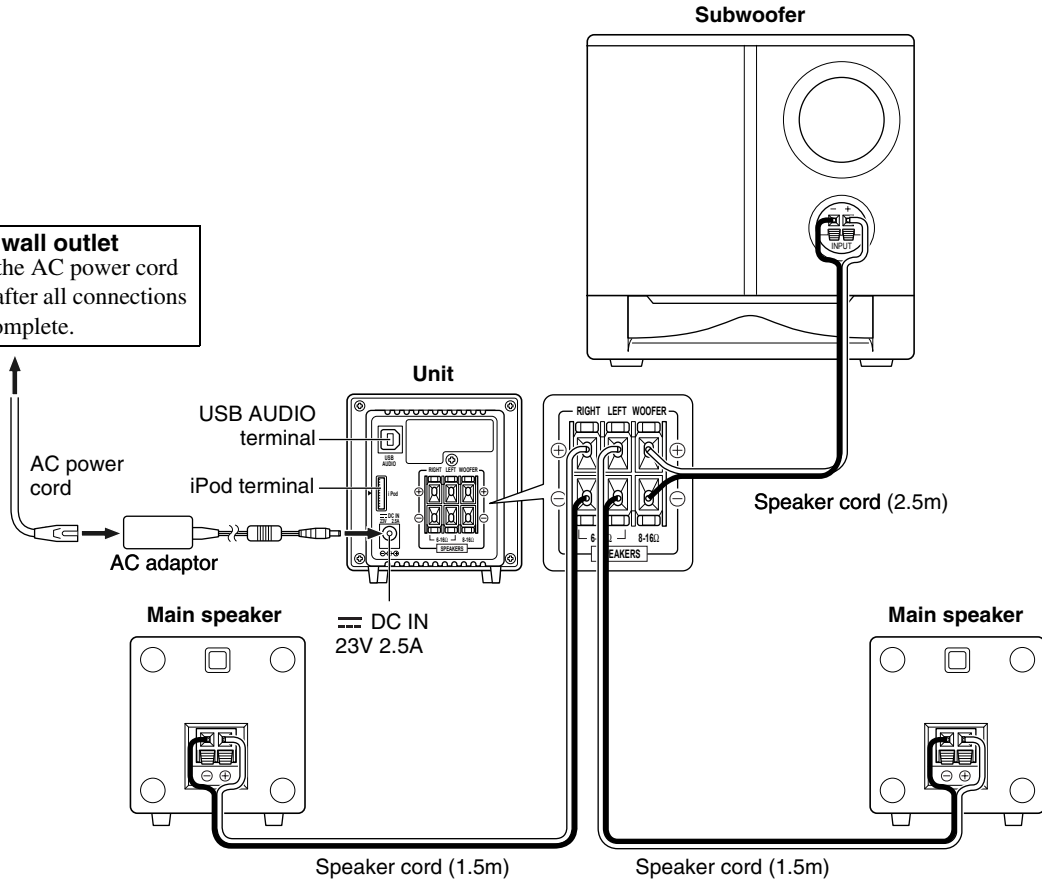

To connect the speaker cords

Make sure the unit, main speakers, and subwoofer are connected correctly and firmly.

When connecting the speaker cords, match the polarity of the speaker terminals: white cord to (+) and white cord with black stripe to (-).

NOTES

- DO NOT connect more than one speaker to each terminal.
- DO NOT allow the conductor of the speaker cords to be in touch with the metallic parts of the System.

e.g. Speaker

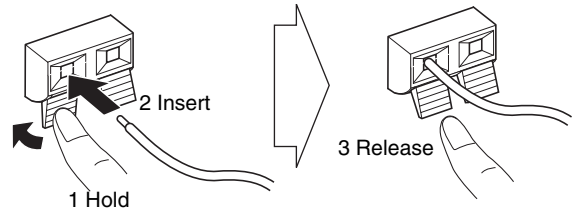

e.g. Unit

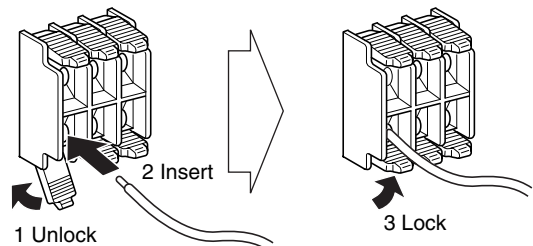

Basic Operations

Unit

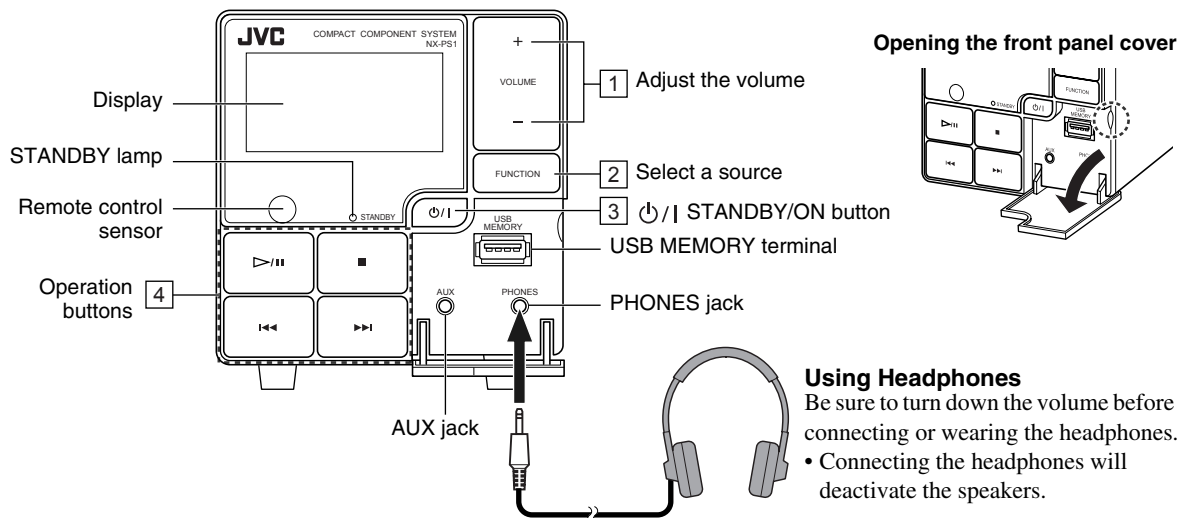

Operating on the Unit

Buttons	Functions
1	Adjusts the volume level VOLUME MIN / 1 to 29 / VOLUME MAX.
2	Selects a source. See "Playing Back from iPod" (P.8). See "Playing Back from USB mass storage class device" (P.9). See "Playing Back from the PC" (P.10). See "Playing Back from Other Equipment" (P.11).

Buttons	Functions
3	Turns on or off (standby) the power.
4	Operates music. See "Playing Back from iPod" (P.8). See "Playing Back from USB" (P.9).

Display Information

Symbols	Description
RND	Lights when Random Play mode is activated. (P.10)
P/I / P/I ALL / P/I GR	Lights when Repeat mode is activated. (P.10)
FLAT/ROCK/POP/JAZZ/CLAS(CLASSIC)	Displays an selected EQ setting. (P.6)
	Lights when the USB mass storage class device is connected and the USB MEMORY mode is selected.
SLEEP	Lights when the Sleep Timer is activated. (P.6)
P/I	Lights when Daily Timer is set. (P.7)

"Random" and "Repeat" can only be set in USB MEMORY mode.

RND P/I FLAT SLEEP P/I

VOLUME 01

iPod

CONNECT

While selecting iPod / USB AUDIO:

VOLUME 10 — Volume level
iPod — Source name
CONNECT — Current status \leftrightarrow Clock display

While selecting USB MEMORY:

Volume level

VOL 10 00:05 — Elapsed playing time
▶ G012 T123 — Current track number
000000000000 — Current group number

File information \leftrightarrow Clock display

While selecting AUX:

VOLUME 10 — Volume level
AUX — Source name
— No display \leftrightarrow Clock display

Remote Control

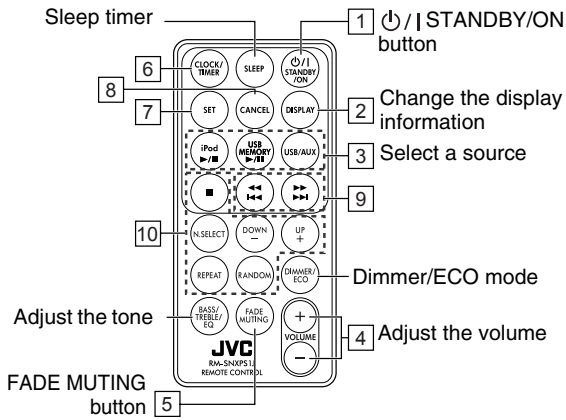

Operating on the Remote Control

Buttons	Functions
1 O/I STANDBY/ON	Turns on or off (standby) the power
2 DISPLAY	Changes the display information. USB MEMORY mode : Clock display \leftrightarrow File information Other mode : Clock display \leftrightarrow Source information
iPod P/II	Changes source to iPod. See "Playing Back from iPod" (P.8).
USB MEMORY P/II	Changes source to USB MEMORY. See "Playing Back from USB mass storage class device" (P.9).
USB/AUX	Changes source to USB audio and AUX. See "Playing Back from the PC" (P.10). See "Playing Back from Other Equipment" (P.11).
+ VOLUME -	Adjusts the volume level VOLUME MIN / 1 to 29 / VOLUME MAX.
FADE MUTING	Drops the volume in a moment. To restore the volume, press again, or adjust the volume level.

Others

Buttons	Reference pages
6 CLOCK/TIMER	CLOCK/TIMER set (P.7)
7 SET	CLOCK/TIMER set (P.7) USB MEMORY (P.9) AUX (P.11)
8 CANCEL	CLOCK/TIMER set (P.7) USB MEMORY (P.9)
9 P/II P/II	CLOCK/TIMER set (P.7) iPod (P.8) USB MEMORY (P.9)
10 DOWN UP N.SELECT REPEAT RANDOM	USB MEMORY (P.9)

To dim the display—DIMMER



Press while the System is turned on.
"DIMMER ON" appears.

- To cancel this function, press DIMMER/ECO again.
"DIMMER OFF" appears.

To set the ECO mode.

In ECO mode, the display goes off and the least power is consumed.



Press While the System is turned off.
"ECO ON" appears and then nothing is displayed.

- To cancel this function, press DIMMER/ECO again.
"ECO OFF" appears and then the clock is displayed.

To turn off the System after a certain period of time—Sleep Timer



Press repeatedly to specify the time (in minutes) as follows:

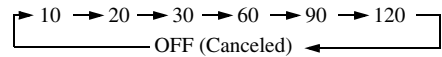

2

Wait until the set time goes off.

- To check the time remaining before the shut-off time, press SLEEP once.
If you press the button repeatedly, you can change the shut-off time

To adjust the tone



Selects an item as follows :

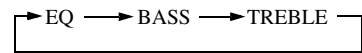

- Adjust the bass and treble level with VOLUME +/- from -5 to +5.
- Select a EQ setting as follows with VOLUME +/-:



ROCK	Boosts low and high frequency. Good for acoustic music.
POP	Good for vocal music.
JAZZ	Good for jazz music.
CLASSIC	Good for classical music.
FLAT	Normal sound.

When the bass or treble level is adjusted, EQ is not effective and EQ symbol disappears.

BASS/TREBLE adjustment will not work at the same time as the EQ. The last setting made will become effective.

Setting the Clock and Daily Timer

Setting the Clock

1 

Activate the clock setting mode (“Clock Adjust” appears).

⇒ The hour digit of the time indication blinks on the display.

• If you have already adjusted the clock before, press the button repeatedly until “Clock Adjust” appears.

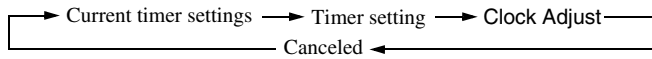

If the clock has not been adjusted, “Clock Adjust” appears first.

2  or  → 

1 Adjust the hour. ⇒ The minute digits of the time indication blink on the display.

2 Adjust the minute. ⇒ The built-in clock starts working.

• To go back to the previous step, press CANCEL.

• If there is a power failure, the clock loses the setting and is reset to “AM 12:00”. You need to set the clock again.

Setting the Daily Timer

Without setting the built-in clock, you cannot use Daily Timer.

Using Daily Timer, you can wake up with music, etc.

Connect the iPod or USB mass storage device, or other equipment, to the Unit beforehand. (P.8, P.9, P.11)

1  (Twice)

Select the timer setting mode.

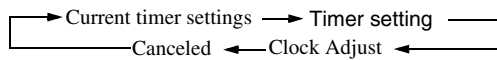

2  or  → 

1 Adjust the hour then the minute for Daily Timer on-time.

2 Adjust the hour then the minute for Daily Timer off-time.

• The on-time and off-time of the Daily Timer cannot be set to the same time.

3 Select the playback source—“iPod,” “USB MEMORY,” or “AUX.”

• If “USB MEMORY” is selected, select the GROUP number (“001” to “500” and “---”) and then select the TRACK number (“001” to “999” and “---”).

If you select “---,” TRACK1 in GROUP1 is set.

4 Select the volume level (“VOLUME MIN / 1 to 29 / VOLUME MAX”).

⇒ “SET OK” appears briefly followed by setting information, then the  icon appears on the display.

3 

Turn off the System (on standby).

• To exit from the timer setting, press CLOCK/TIMER as required.

• To correct a misentry during the process, press CANCEL. You can return to the previous step.

To cancel the Daily Timer

1 

Select the current timer settings mode.

2 

⇒  icon disappears.

To turn on the Daily Timer again (Turn on a timer setting you have made beforehand.)

1 

Select the current timer settings mode.

2 

⇒  icon appears on the display.

Playing Back from iPod

This system is equipped with an iPod terminal on the rear panel. You can connect your iPod to this terminal and enjoy the sound from your iPod.

Compatible iPod types:

iPod nano 1G/2G/4G
iPod mini
iPod (4th Generation) 20G/40G
iPod photo (4th Generation) 20G/30G/40G/60G
iPod video (5th Generation) 30G/60G

If the iPod does not play correctly, please update your iPod software to the latest version.

- For details about updating your iPod, check on the Apple web site <<http://www.apple.com>>.

iPod is a trademark of Apple Computer, Inc., registered in the U.S. and other countries.

To Connect iPod

Connect the iPod to the System using the supplied cable. Make sure the System is turned off when you connect it.

Connect the arrow of iPod terminal and the arrow of the connector facing each other.

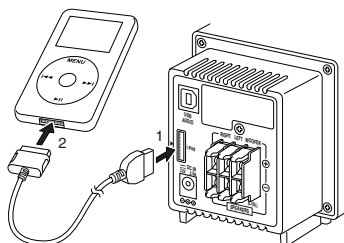

You can place the iPod on the supplied iPod stand.

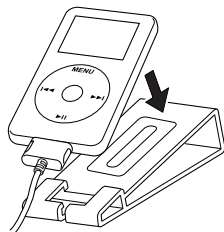

When disconnecting the iPod, make sure that the System is turned off.

To remove the connector from your iPod, squeeze the buttons on the sides and pull.

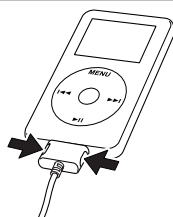

Basic Operations

Button		Function
On the Unit	On the remote	
		Start playback / Pause Press and hold : The iPod is in sleep mode
		Increase the track numbers Press and hold : Fast forward search
		Decrease the track numbers Press and hold : Fast reverse search

NOTES

- The iPod battery is charged while the System is turned on or on standby (except in ECO mode). See the iPod instruction manual about battery charging.
- If you connect an iPod to the iPod terminal and a USB mass storage class device to the USB MEMORY terminal at the same time, the system might be overloaded.
- Sound distortion may occur when playing back audio sources with high recording levels. When distortion occurs, it is recommended to turn off the equalizer of the iPod. For information on operating the iPod, see the iPod instruction manual.
- JVC is not responsible for any loss of or damage to iPod that might result from the use of this product.
- When you connect your iPod to the cable, make sure it connects all the way in.
- Do not carry the System with iPod connected. You might drop it down or it might cause damages to the connector part.
- Do not touch or hit the iPod terminal pins or the connector pins directly. It might cause damages to the connector part.
- Remove the iPod from the cable when you do not use.
- Always set volume to the minimum level when connecting or disconnecting the other equipment.

Playing Back from USB mass storage class device

This System is equipped with a USB MEMORY terminal on the front panel. You can connect a USB mass storage class device such as a USB flash memory device, Digital Audio Player (DAP), etc. to this System.

This System cannot recognize a USB mass storage class device whose rating exceeds 5V/500mA.

To connect the USB mass storage class device

When connecting a USB mass storage class device, refer also to its manual.

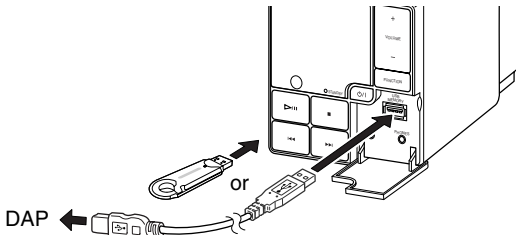

- When disconnecting the USB mass storage class device, make sure that the System is in the stop condition.

Basic Operations

Button		Function
On the Unit	On the remote	
		Starts playback / Pauses
		Stops playback
		Increases the track numbers. Press and hold : Fast forward search
		Decreases the track numbers. Press and hold : Fast reverse search

● For MP3/WMA playback



- Set Number select mode.
- or → Input the Group number, then input the Track number.
- Start playback.

- To exit from the Number select mode, press CANCEL.



NOTES

- You cannot send any data to your USB mass storage class device from this System.
- Always set volume to the minimum level when connecting or disconnecting the other equipment.
- Connect the USB mass storage class device directly to the system. Using a USB hub may result in malfunction.
- Coded or encrypted tracks in a special method cannot be played on the unit.
- The USB mass storage device's battery is charged while the System is turned on or on standby (except in ECO mode).
- An iPod does not play on the USB MEMORY terminal. "RESTRICT" appears on the display when an iPod is connected to the USB MEMORY terminal while USB MEMORY is selected for the source.
- This System may not playback some USB mass storage devices and does not support DRM (Digital Rights Management).
- Some MP3/WMA files cannot be played back and will be skipped. This result from their recording processes and conditions.
- This System can play back MP3/WMA files with the extension code <.mp3> or <.wma> (regardless of the letter case—upper/lower).
- Some characters or symbols will not be shown correctly on the display. The maximum character number shown on the display is 32 (without the extension code) for files, and 30 for ID3 tag.
- It is recommended that you make each MP3 file at a sampling rate of 44.1 kHz and at a bit rate of 128 kbps. Similarly each WMA file at a sampling rate of 44.1 kHz and at a bit rate of 96 kbps.
- Playback order of MP3/WMA tracks may be different from the one you have intended while recording. If a folder does not include MP3/WMA tracks, they are ignored.

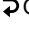
Repeat Play

	Press repeatedly before you start playback to specify the repeat mode as follows:
1	 1 Repeats the current track.
	 ALL Repeats all tracks.
	 GR Repeats all tracks in the current group.
	Cancel
2	Start playback.

Random Play

1	 RND appears on the display before you start playback. <ul style="list-style-type: none"> To cancel, press again.
2	 Playback starts in random order. Random Play ends when all tracks are played. <ul style="list-style-type: none"> To repeat random play, press REPEAT.

Playing Back from the PC

This System is equipped with a USB AUDIO terminal on the rear panel. You can connect your PC to this terminal and enjoy the sound from your PC. When you connect your PC for the first time, follow the procedure below.

How to install the USB drivers

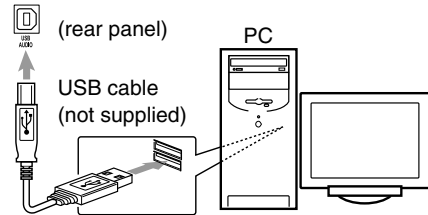
1	<p>Turn on your PC and start running Windows[®] 98SE, Windows[®] Me, Windows[®] 2000, or Windows[®] XP.</p> <ul style="list-style-type: none"> If the PC has been turned on, close all the applications running.
2	<p>Select USB AUDIO for the source.</p>  <ul style="list-style-type: none"> USB AUDIO can be selected also by the FUNCTION button on the unit.
3	<p>Connect the System to the PC using a USB cable (not supplied).</p>  <ul style="list-style-type: none"> Use "USB series A plug to B plug" cable.
4	The USB drivers are installed automatically.

To playback sounds on the PC

Refer to the manuals supplied with the media player application installed on the PC.

* Microsoft[®], Windows[®] 98SE, Windows[®] Me, Windows[®] 2000 and Windows[®] XP are registered trademarks of Microsoft corporation.

NOTES

- You cannot send any signal or data to your PC from this System.
- DO NOT turn off the unit or disconnect the USB cable while installing the drivers and for several seconds while your PC is recognizing the receiver.
- Use a full speed USB cable (version 1.1). Recommended cord length is shorter than approximately 2 m.
- If your PC does not recognize the unit, disconnect the USB cable and connect it again. If it does not work yet, restart Windows.
- The installed drivers can be recognized only when the USB cable is connected between the unit and your PC.
- The sound may not be played back correctly—interrupted or degraded—due to your PC settings and PC specifications.

NOTE

- Always set volume to the minimum level when connecting or disconnecting the other equipment.

Playing Back from Other Equipment

To connect other equipment

By using a stereo mini plug cord (not supplied), you can connect other equipment with analog audio output jacks, such as Digital Audio Player, a TV, etc.

Stereo mini plug cord (not supplied)

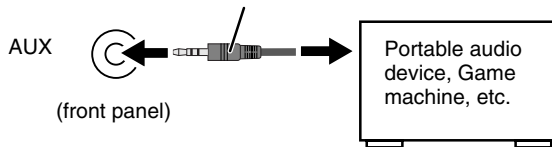

- Refer to the manuals supplied with the other equipment.

NOTE

- Always set volume to the minimum level when connecting or disconnecting the other equipment.

To select other equipment for the source

Select AUX for the source.

- AUX can be selected also by the FUNCTION button on the unit.

To adjust the sound input level from other equipment

You can adjust the sound input level from the connected equipment, if the incoming signal is too small or too large.

1 Select AUX for the source.

2  Press and hold until the indicator appears on the display. Then press and hold until setting is changed.

LEVEL 1:
Decreased input level. Suitable for equipment with high output level (such as a DVD player).

LEVEL 2:
Ordinary input level (factory setting).
Suitable for equipment with low output level (such as a portable audio device).

Troubleshooting

If you are having a problem with your System, check this list for a possible solution before calling for service.

General:

Power does not come on.

- ⇒ Power plug is not inserted securely. Plug in securely.

Adjustments or settings are suddenly canceled before you finish.

- ⇒ There is a time limit. Repeat the procedure again.

Operations are disabled.

- ⇒ The built-in microprocessor may malfunction due to external electrical interference. Unplug the AC power cord and then plug it back in.

Unable to operate the System from the remote control.

- ⇒ The path between the remote control and the remote sensor on the System is blocked.
- ⇒ Point it at the remote sensor on the front panel.
- ⇒ Signals cannot reach the remote sensor.
- ⇒ Move closer to the System.
- ⇒ The batteries are exhausted.

No sound is heard from the speakers.

- ⇒ Speaker connections are incorrect or loose (P.4).
- ⇒ Headphones are connected (P.5).

Sound from PC connected with a USB cable has some noise. (P.10)

- ⇒ PC is subjected to excessive load due to using other applications. Close the applications you do not use.
- ⇒ PC is connected via USB Hub. Connect the PC directly to the main unit with a USB cable.

iPod/USB mass storage class device Operations:

The iPod doesn't playback although the display indicates CONNECT.

- ⇒ The battery is empty. Let stand for more than approximately ten minutes on the connecting condition.

Timer Operations:

Daily Timer does not work.

- ⇒ The System has been turned on when the ontime comes. Timer starts working only when the System is turned off.
- ⇒ There might have been a power failure. Set the clock first, then the timer again.

Specifications

Amplifier

Output Power	
Main Speaker	10 W per channel, min. RMS, driven into 6Ω at 1kHz, with no more than 10% total harmonic distortion
Subwoofer	30W, min. RMS, driven into 8Ω at 100Hz, with no more than 10% total harmonic distortion

Terminals

Input Sensitivity/Impedance (1 kHz)	
AUX IN	LEVEL1 500 mV/47 kΩ LEVEL2 125 mV/47 kΩ
USB AUDIO	Ver. 1.1
USB MEMORY	Ver. 1.1
Compatible device	Mass Storage Class
Compatible file system	FAT16, FAT32
Bus power supply iPod	Max. 5V/500 mA
Compatible iPod types	See Page 8
Bus power supply	Max. 5V/500 mA
Speaker terminals	Main speaker 6Ω-16Ω Subwoofer 8Ω-16Ω
PHONES	32Ω - 1 kΩ 15 mW/ch output into 32Ω

Unit

Dimensions	90mm × 96mm × 137mm (3- ⁹ / ₁₆ " × 3- ¹³ / ₁₆ " × 5- ⁷ / ₁₆ " (W/H/D)
Mass	Approx. 0.5kg (1.1lbs)

Speaker Specifications

Main speaker SP-NXPS1F (each unit)	
Type	Full range bass-reflex type
Speaker Unit	7.5 cm (3") cone × 1
Power handling Capacity	10 W
Impedance	6Ω
Frequency Range	150 Hz - 20 kHz
Sound pressure level	83 dB/W • m
Dimensions	90mm × 96mm × 90mm (3- ⁹ / ₁₆ " × 3- ¹³ / ₁₆ " × 3- ⁹ / ₁₆ " (W/H/D)
Mass	Approx. 0.63kg (1.4lbs)

Subwoofer SP-NXPS1W

Type	Bass Reflex Type
Speaker Unit	16 cm (6- ⁵ / ₁₆ ") cone × 1
Power handling Capacity	30 W
Impedance	8Ω

Frequency Range	35 Hz - 150Hz
Sound pressure level	80 dB/W • m
Dimensions	221mm × 221mm × 222mm (8-3/4" × 8-3/4" × 8-3/4") (W/H/D)
Mass	Approx. 3.5kg (7.8lbs)

Accessories

See Page 3

Power Specifications

NX-PS1 (System)	
Power Requirements	AC 110V-240V ~ 50Hz/60Hz
Power Consumption	19 W (power on mode) 12 W (in Standby mode) 1 W (in ECO mode)
AC Adaptor (AA-R2401)	
INPUT	AC 110V-240V ~ 50Hz/60Hz 1.5A
OUTPUT	DC 23V = 2.5A, 57.5VA
CA-NXPS1 (Main Unit)	
Power Requirements	DC IN 23V = 2.5A

Design and specifications are subject to change without notice.

TO OUR VALUED CUSTOMER _____

THANK YOU FOR PURCHASING THIS JVC PRODUCT.
WE WANT TO HELP YOU ACHIEVE A PERFECT EXPERIENCE.

**NEED HELP ON HOW TO HOOK UP?
NEED ASSISTANCE ON HOW TO OPERATE?
NEED TO LOCATE A JVC SERVICE CENTER?
LIKE TO PURCHASE ACCESSORIES?**

JVC[®] IS HERE TO HELP!
TOLL FREE: 1(800)252-5722
<http://www.jvc.com>

Remember to retain your Bill of Sale for Warranty Service.

_____ **Do not attempt to service the product yourself** _____

Caution

To prevent electrical shock, do not open the cabinet.
There are no user serviceable parts inside.
Please refer to qualified service personnel for repairs.



LIMITED WARRANTY

1-1 USA ONLY

ONLY FOR PRODUCT PURCHASED IN U.S.A.

JVC Americas Corp. (JVC) warrants this product and all parts thereof, except as set forth below ONLY TO THE ORIGINAL RETAIL PURCHASER to be FREE FROM DEFECTIVE MATERIALS AND WORKMANSHIP from the date of original purchase for the period shown below. ("The Warranty Period")

PARTS	1 YR	LABOR	1 YR
-------	-------------	-------	-------------

THIS LIMITED WARRANTY IS VALID ONLY IN THE FIFTY (50) UNITED STATES, THE DISTRICT OF COLUMBIA AND IN THE COMMONWEALTH OF PUERTO RICO.

WHAT WE WILL DO:

If this product is found to be defective within the warranty period, JVC will repair or replace defective parts with new or rebuilt equivalents at no charge to the original owner. Such repair and replacement services shall be rendered by JVC during normal business hours at JVC authorized service centers. Parts used for replacement are warranted only for the remainder of the Warranty Period. All products may be brought to a JVC authorized service center on a carry-in basis. Color televisions with a screen size of 27" or greater qualify for in-home service. In such cases, a technician will come to your home and either repair the TV there or remove and return it if it cannot be repaired in your home.

WHAT YOU MUST DO FOR WARRANTY SERVICE:

Please do not return your product to the retailer
Instead, return your product to the JVC authorized service center nearest you. If shipping the product to the service center, please be sure to package it carefully, preferably in the original packaging, and include a brief description of the problem(s). Please call 1-800-252-5722 to locate the nearest JVC authorized service center. Service locations can also be obtained from our website <http://www.jvc.com>. If your product qualifies for in-home service, the service representative will require clear access to the product.

If you have any questions concerning your JVC Product, please contact our Customer Care Center at 800-252-5722

WHAT IS NOT COVERED:

This limited warranty provided by JVC does not cover:

1. Products which have been subject to abuse, accident, alteration, modification, tampering, negligence, misuse, faulty installation, lack of reasonable care, or if repaired or serviced by anyone other than a service facility authorized by JVC to render such service, or if affixed to any attachment not provided with the products, or if the model or serial number has been altered, tampered with, defaced or removed;
2. Initial installation, installation and removal from cabinets or mounting systems.
3. Operational adjustments covered in the Owner's Manual, normal maintenance, video and audio head cleaning;
4. Damage that occurs in shipment, due to act of God, and cosmetic damage;
5. Signal reception problems and failures due to line power surge;
6. User Removal Memory Devices/Video Pick-up Tubes/CCD Image Sensors are covered for 90 days from the date of purchase;
7. Accessories;
8. Batteries (except that Rechargeable Batteries are covered for 90 days from the date of purchase);
9. Products used for commercial purposes, including, but not limited to rental.
10. Loss of data resultant from malfunction of hard drive or other data storage device;

There are no express warranties except as listed above.

THE DURATION OF ANY IMPLIED WARRANTIES, INCLUDING THE IMPLIED WARRANTY OF MERCHANTABILITY, IS LIMITED TO THE DURATION OF THE EXPRESS WARRANTY HEREIN.

JVC SHALL NOT BE LIABLE FOR ANY LOSS OF USE OF THE PRODUCT, INCONVIENCE, OR ANY OTHER DAMAGES, WHETHER DIRECT, INCIDENTAL OR CONSEQUENTIAL (INCLUDING, WITHOUT LIMITATION, DAMAGE TO TAPES, RECORDS OR DISCS) RESULTING FROM THE USE OF THIS PRODUCT, OR ARISING OUT OF ANY BREACH OF THIS WARRANTY. ALL EXPRESS AND IMPLIED WARRANTIES, INCLUDING THE WARRANTIES OF MERCHANTABILITY AND FITNESS FOR PARTICULAR PURPOSE, ARE LIMITED TO THE WARRANTY PERIOD SET FORTH ABOVE.

Some states do not allow the exclusion of incidental or consequential damages or limitations on how long an implied warranty lasts, so these limitations or exclusions may not apply to you. This warranty gives you specific legal rights and you may also have other rights which vary from state to state.

JVC AMERICAS CORP.

1700 Valley Road, Wayne, New Jersey 07470

<http://www.jvc.com>

REFURBISHED PRODUCTS CARRY A SEPARATE WARRANTY, THIS WARRANTY DOES NOT APPLY. FOR DETAIL OF REFURBISHED PRODUCT WARRANTY, PLEASE REFER TO THE REFURBISHED PRODUCT WARRANTY INFORMATION PACKAGED WITH EACH REFURBISHED PRODUCT.

For customer use:

Enter below the Model No. and Serial No. which is located either on the rear, bottom or side of the cabinet. Retain this information for future reference.

Model No. : _____

Serial No. : _____

Purchase date : _____

Name of dealer : _____

JVC