

JVC

CD PORTABLE SYSTEM

RC-EX26B

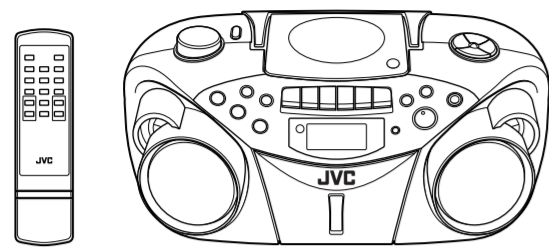

INSTRUCTIONS

Thank you for purchasing this JVC product. Please read these instructions carefully before starting operation to be sure to obtain optimum performance and a longer service life from the unit.

0205NSMBICORI
EN ©2005 Victor Company of Japan, Limited

LVT1382-001B [J/C]

SAFETY PRECAUTIONS



The lightning flash with arrowhead symbol, within an equilateral triangle is intended to alert the user to the presence of uninsulated "dangerous voltage" within the product's enclosure that may be of sufficient magnitude to constitute a risk of electric shock to persons.



The exclamation point within an equilateral triangle is intended to alert the user to the presence of important operating and maintenance (servicing) instructions in the literature accompanying the appliance.

For U.S.A.

This equipment has been tested and found to comply with the limits for a Class B digital device, pursuant to part 15 of the FCC Rules. These limits are designed to provide reasonable protection against harmful interference in a residential installation. This equipment generates, uses and can radiate radio frequency energy and, if not installed and used in accordance with the instructions, may cause harmful interference to radio communications. However, there is no guarantee that interference will not occur in a particular installation. If this equipment does cause harmful interference to radio or television reception, which can be determined by turning the equipment off and on, the user is encouraged to try to correct the interference by one or more of the following measures: Reorient or relocate the receiving antenna. Increase the separation between the equipment and receiver. Connect the equipment into an outlet on a circuit different from that to which the receiver is connected. Consult the dealer or an experienced radio/TV technician for help.

For Canada

CAUTION: TO PREVENT ELECTRIC SHOCK, MATCH WIDE BLADE OF PLUG TO WIDE SLOT, FULLY INSERT. THIS DIGITAL APPARATUS DOES NOT EXCEED THE CLASS B LIMITS FOR RADIO NOISE EMISSIONS FROM DIGITAL APPARATUS AS SET OUT IN THE INTERFERENCE-CAUSING EQUIPMENT STANDARD ENTITLED "DIGITAL APPARATUS," ICES-003 OF THE DEPARTMENT OF COMMUNICATIONS.

WARNING: TO REDUCE THE RISK OF FIRE OR ELECTRIC SHOCK, DO NOT EXPOSE THIS APPLIANCE TO RAIN OR MOISTURE.

Caution — STANDBY/ON switch!

Disconnect the mains plug to shut the power off completely. The STANDBY/ON switch in any position does not disconnect the mains line. The power can be remote controlled.

CAUTION

To reduce the risk of electrical shocks, fire, etc.:
1. Do not remove screws, covers or cabinet.
2. Do not expose this appliance to rain or moisture.

IMPORTANT FOR LASER PRODUCTS

- CLASS 1 LASER PRODUCT
- CAUTION:** Do not open the top cover. There are no user serviceable parts inside the unit; leave all servicing to qualified service personnel.
- CAUTION:** Visible and invisible laser radiation when open and interlock failed or defeated. Avoid direct exposure to beam.
- REPRODUCTION OF LABEL: CAUTION LABEL, PLACED INSIDE THE UNIT.

CAUTION - INVISIBLE LASER RADIATION WHEN OPEN AND INTERLOCKS DEFEATED. AVOID EXPOSURE TO BEAM.
VORSICHT ! UNSICHTBARE LASERSTRAHLUNG TRITT AUS, WENN DECKEL GEÖFFNET UND WENN SICHERHEITSVERRIEGELUNG ÜBERBRÜCKT IST. NICHT DEM STRAHL AUSSETZEN!
WARNING - OSYNLIG LASERSTRÅLNING NÄR DENNA DEL ÄR ÖPPNAD OCH SPÄRR ÄR URKOPPLAD STRÅLEN ÄR FÄRLIG.
ADVARSEL - USYNLIG LASERSTRÅLING VED ÅBNING NÄR SIKKERHEDSÅBRYDERE ER UDE AF FUNKTION. UNDGÅ UDSÆTTELSE FOR STRÅLING.

FIRST THINGS

This portable system operates on battery or AC power.

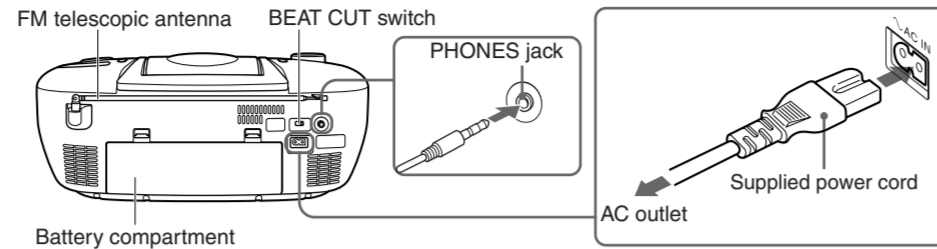

INSERTING BATTERIES

1 Open the battery compartment cover.
Pull the battery compartment cover toward you while pressing the sections marked by the arrows.

2 Insert six R20 (SUM-1)/D (13D)-size batteries. (not supplied)
Be sure to insert the batteries with the (+) and (-) terminals positioned correctly.

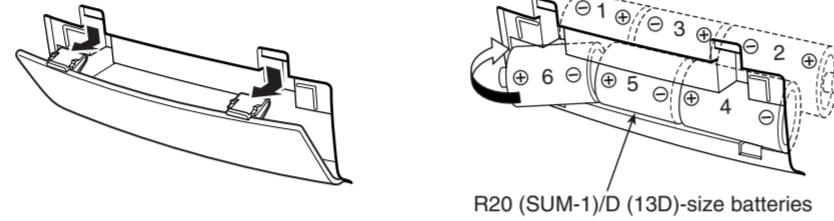

3 Replace the battery compartment cover.

Inserting Batteries into the Remote Control Unit:
Match the polarity (+ and -) of the batteries. R03 (UM4)/AAA (24F)×2 (not supplied)

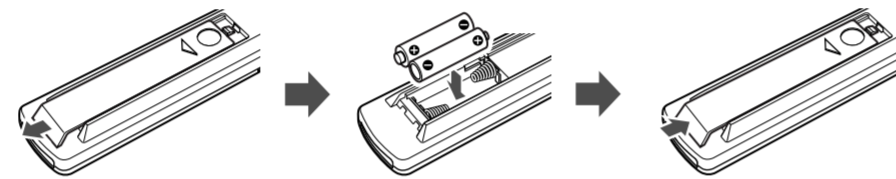

Note: The battery power will be switched off when you plug the power cord into the ~ AC IN jack on the unit.

CAUTION:
To avoid battery leakage or explosion, handle batteries properly.
• If you are not going to use your system for a month or more, remove the batteries from the battery compartment.
• Dispose of batteries in the proper manner, according to federal, state, and local regulations.
• Do not mix with different battery types or with new and old ones, or do not attempt to charge a battery not intended to be recharged.
• Discard leaky batteries immediately. Leaking batteries can cause skin burns or other personal injury.

SUPPLYING AC POWER

Plug the power cord into the ~ AC IN jack on the back of the unit, and into an AC power outlet.
Note: To switch off the system completely, unplug the power cord.

CAUTIONS:

- ONLY USE JVC POWER CORD PROVIDED WITH THIS UNIT TO AVOID MALFUNCTION OR DAMAGE TO THE UNIT. REMOVE BATTERIES WHEN USING THE POWER CORD.**
- BE SURE TO UNPLUG THE POWER CORD FROM THE OUTLET WHEN GOING OUT OR WHEN THE UNIT IS NOT IN USE FOR AN EXTENDED PERIOD OF TIME.**

USING HEADPHONES

Connect commercially available headphones to the PHONES jack on the rear of the main unit. While the headphones are connected, the speakers do not produce any sound. Before connecting the headphones, make sure to turn down the sound volume.

ANTENNAS

The AM antenna is built in, so adjusting the position of the unit may help AM reception. The FM telescopic antenna on the back of the unit can be extended and rotated for better FM reception.

NAMES OF PARTS AND CONTROLS

Top and front sides:

Main unit

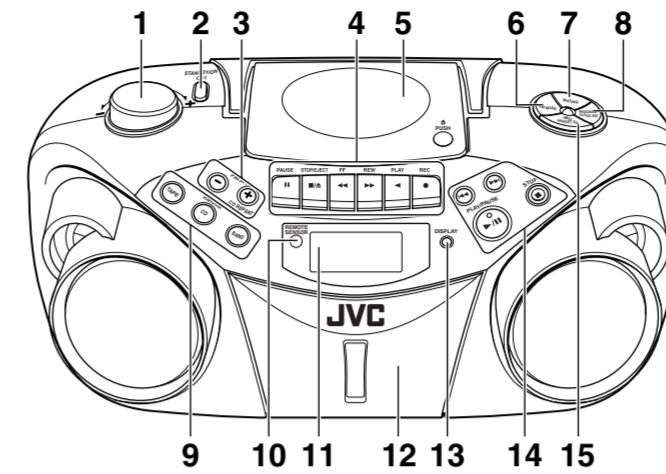

- | | |
|-------------------------------|----------------------|
| 1 VOLUME knob | 9 TAPE button |
| 2 STANDBY/ON button | 10 CD/RANDOM button |
| 3 PRESET - button | 11 TUNER/BAND button |
| 4 PRESET + / CD REPEAT button | 12 REMOTE SENSOR |
| 5 Tape operation buttons | 13 Display window |
| PAUSE button | 14 Cassette deck |
| STOP/EJECT button | 15 DISPLAY button |
| FF button | |
| REW button | |
| PLAY button | |
| REC button | |
| 6 CD door | |
| 7 FM MODE button | |
| 8 MUTING button | |
| PROGRAM/CLOCK SET button | |

Names of buttons:

Remote control unit

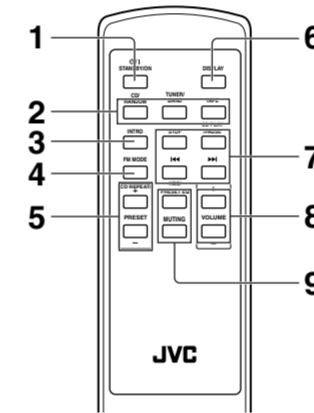

- | | |
|------------------------------|------------------------|
| 1 STANDBY/ON button | 6 DISPLAY button |
| 2 CD/RANDOM button | 7 STOP button |
| TUNER/BAND button | 8 CD PLAY/PAUSE button |
| TAPE button | button |
| 3 INTRO button | button |
| 4 FM MODE button | 9 VOLUME + button |
| 5 PRESET + /CD REPEAT button | VOLUME - button |
| PRESET - button | 9 HBS/PRESET EQ button |
| | MUTING button |

GENERAL CONTROLS

STANDBY/ON - Press to turn on/off the unit.
The display window lights up when the unit is turned on. (Note, however, that the display window does not light even when the unit is turned on if the unit is operated on batteries.)

SETTING THE CLOCK

- Press DISPLAY.
The clock flashes on the display window.
- Press and hold PROGRAM/CLOCK SET for more than 2 seconds.
The hour digits start flashing.
- Press or to adjust the hour, then press PROGRAM/CLOCK SET.
The minute digits start flashing.
- Press or adjust the minutes, then press PROGRAM/CLOCK SET.

Notes:

- If there is a power failure, the clock loses the setting and is reset to "AM 12:00." The clock indication will keep flashing until you set the clock again.
- You can also set the clock when the unit is in STANDBY mode. In this case, follow the procedures from step 2.

To show the clock when CD or tuner is selected.

Press DISPLAY.
Each time you press the button, the display changes the clock indication and the normal indication alternately. (Operating the unit while clock indication is displayed changes the display to the normal indication.)

ADJUSTING THE SOUND

Turn the VOLUME knob (or press VOLUME + / - button on the remote control unit) to increase or decrease the volume to desired level. The volume level can be adjusted in 31 steps from "00" to "30".

- Turning off the sound temporarily**
During playback, press MUTING to turn the sound off. The MUTING indicator appears in the display window. Press it again to restore the sound.
- Reinforcing the bass sound**
Press and hold HBS/PRESET EQ so that the HBS indicator appears in the display window. You can enjoy powerful bass sound with the Hyper-Bass Sound effect.

- Selecting the sound mode**
You can select one of the 5 preset sound modes.
Press HBS/PRESET EQ repeatedly until the indicator for the sound mode you want appears in the display window.

- CLASSIC:** Enriched sound with fine treble and ample bass.
- ROCK :** Powerful sound emphasizing treble and bass.
- POP :** More presence in the vocals and midrange.
- JAZZ :** Accented lower frequencies for jazz-type music.
- FLAT :** Equalizer effect is canceled.

USING THE RADIO

TUNING IN RADIO STATIONS

- Press TUNER/BAND to enter the tuner mode.
- Press TUNER/BAND to select the band, FM or AM.
- Press and hold or for more than 1 second.
The unit starts searching and stops when a station of sufficient signal strength is tuned in.
If you press or briefly and repeatedly, the frequency changes step by step.

Changing the FM reception mode

When an FM stereo broadcast is hard to receive or noisy, press FM MODE so that the MONO indicator appears in the display window.
To restore the stereo effect, press FM MODE again so that the MONO indicator goes off. The MONO will be cancelled also when changing the station.

PRESETTING STATIONS

You can preset 10 FM and 10 AM stations.

- Press TUNER/BAND to select the band, FM or AM.
- Press or to tune in the station you want to preset.
- Press PROGRAM/CLOCK SET.

The PROG indicator starts blinking in the display window.

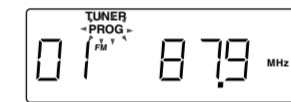

- Press PRESET + /CD REPEAT or PRESET - to select the preset number while the PROG indicator is blinking.

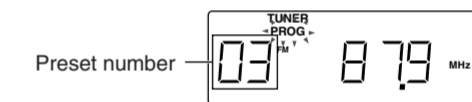

- Press PROGRAM/CLOCK SET while the PROG indicator is blinking.
The tuned station in step 2 is stored in the preset number selected in step 4. Storing a new station on a used number erases the previously stored one.
- Repeat steps 2 to 5 to preset other stations, using different preset numbers.

Tuning in a preset station

- Press TUNER/BAND to select the band, FM or AM.
- Press PRESET + /CD REPEAT or PRESET - repeatedly until the desired preset number appears.

Notes:

- In some cases, test frequencies have been already memorized for the tuner since the factory examined the tuner preset function before shipment. This is not a malfunction. You can preset the stations you want into memory by following the presetting method.
- If you unplug the AC power cord or if a power failure occurs, the preset stations will be erased in a few days. If this happens, preset the stations again.

USING THE TAPE

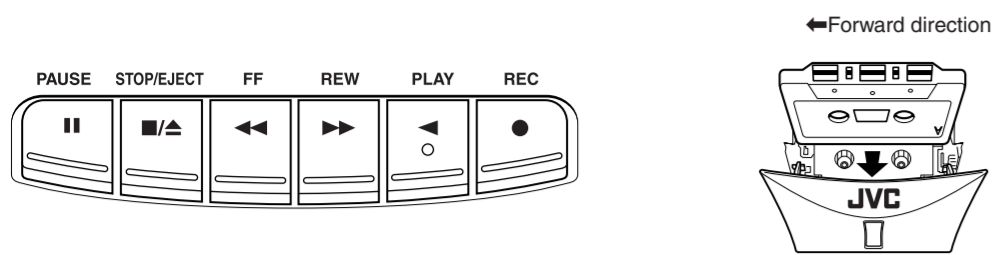

PAUSE **II** – Press to interrupt tape play or record mode. Press a second time to resume tape play or tape record mode.

STOP/EJECT **■/▲** – Press to stop the current tape activity, or to open the cassette compartment door when no buttons are active.

FF **◀◀** – In stop mode, press to advance the tape toward the end. (When the tape reaches the end, press STOP/EJECT **■/▲** to release the depressed button.)

REW **▶▶** – In stop mode, press to rewind the tape toward the beginning. (When the tape reaches the end, press STOP/EJECT **■/▲** to release the depressed button.)

PLAY **▶** – Press to play cassettes.

REC **●** – Press to record from the radio or CD player.

PLAYING A CASSETTE TAPE

1. Press TAPE to enter the tape mode.
2. Press STOP/EJECT **■/▲** to open the cassette compartment door.
3. Load a cassette. Use only a type-I normal tape.
4. Close the door securely.
5. Press PLAY **▶** to begin playing the tape. The cassette tape plays until it reaches the end of the side, then it automatically stops.

Fast-winding a tape

Press REW **▶▶** or FF **◀◀**.

When the tape reaches the end, press STOP/EJECT **■/▲** to release REW **▶▶** or FF **◀◀**.

RECORDING ON CASSETTE TAPES

You can record from the radio or the CD player.

- **It should be noted that it may be unlawful to re-record pre-recorded tapes, records, or discs without the consent of the owner of copyright in the sound or video recording, broadcast or cable program and in any literary, dramatic, musical, or artistic work embodied therein.**
- The recording level is automatically set correctly, so it is not affected by the other sound settings. Thus, during recording you can adjust the sound you are actually listening to without affecting the recording level.
- If recordings you have made have excessive noise or static, the unit may be too close to a TV. Increase the distance between the TV and the unit.
- You can only use type I tape for recording.
- DO NOT turn off the unit while playing back or recording a tape. The cassette deck or tapes may be damaged.
- DO NOT use type II and type IV tapes since the unit is not compatible with such tapes.
- The use of C-120 or longer tape is not recommended, since characteristic deterioration may occur and this tape easily jams in the pinch rollers and the capstans.

To protect your recordings

Cassettes have two small tabs on the back to protect against unexpected erasure or re-recording.

To protect your recording, remove these tabs.

To re-record on a protected tape, cover the holes with adhesive tape.

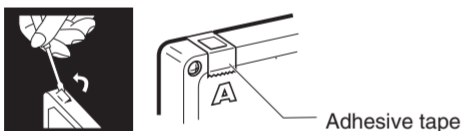

RECORDING FROM THE RADIO

1. Insert a cassette tape into the cassette deck and close the door.
2. Press TUNER/BAND and select a radio station.
3. Press REC **●** to begin recording. REC **●** and PLAY **▶** are locked down.
4. Press STOP/EJECT **■/▲** to stop recording.

When recording an AM broadcast

When recording an AM broadcast, beats may occur. If this happens, set the BEAT CUT switch to "1" or "2."

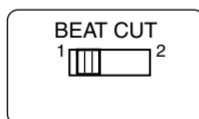

TIP

To temporarily pause the recording, press PAUSE **II** on the cassette deck. Press PAUSE **II** again to resume recording.

SYNCHRONIZED RECORDING FROM A CD

1. Insert a cassette tape into the cassette deck and close the door.
2. Press CD/RANDOM.
3. Place a CD you want to record into CD compartment.
4. Select the track you want to record by pressing **◀◀** or **▶▶**.
5. Press REC **●** to start synchronized recording.

Notes:

- When the tape reaches the end, the CD playback enters in pause.
 - To continue recording: turn over the tape and press REC **●**.
 - To continue the CD playback: press PLAY/PAUSE **▶/II**.
 - To stop the CD playback: press STOP **■**.
- When the CD playback stops, the cassette tape continues running.
 - To stop the cassette tape, press STOP/EJECT **■/▲**.

TIP

Using the PAUSE **II** button on the cassette deck instead of the STOP/EJECT **■/▲** button to momentarily interrupt recording gives you a much clearer sound recording.

ERASING

When recording on a pre-recorded tape, the previous recording is erased and only the new recording is heard next time the tape is played back.

Erasing a recording on a tape without making a new recording

1. Press TAPE to enter the tape mode.
2. Press REC **●** to start recording.

USING THE CD

THINGS TO KNOW BEFORE PLAYING CDs

Playable CDs:

Only CDs bearing these marks can be used with this system.



This unit has been designed only to play back the following CDs.

- Digital audio CD
- Recordable digital audio CD (CD-R)
- Rewritable digital audio CD (CD-RW)

When playing a CD-R or CD-RW

You can play back **finalized CD-R or CD-RW** recorded in **music CD format**. (If a CD-RW has been recorded in a different format, erase all the data on the CD-RW completely before recording on it.)

- You can play back CD-R or CD-RW like an audio CD.
- Some CD-R or CD-RW may not be played back on this unit because of their disc characteristics, damage or stain on them, or if the player lens is dirty.
- The reflection factor of CD-RW is lower than that of other CDs, possibly causing CD-RW to take longer time to read.
- CD-R and CD-RW of MP3 format cannot be played back.

Caution for DualDisc playback

The Non-DVD side of a "DualDisc" does not comply with the "Compact Disc Digital Audio" standard. Therefore, the use of Non-DVD side of a DualDisc on this product may not be recommended.

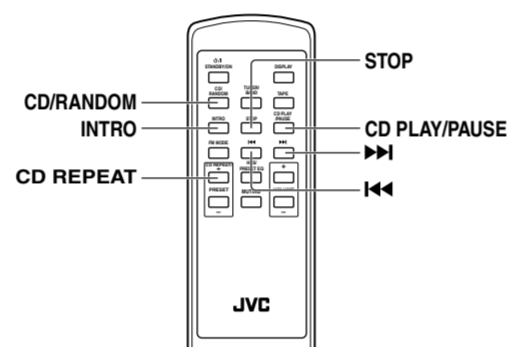
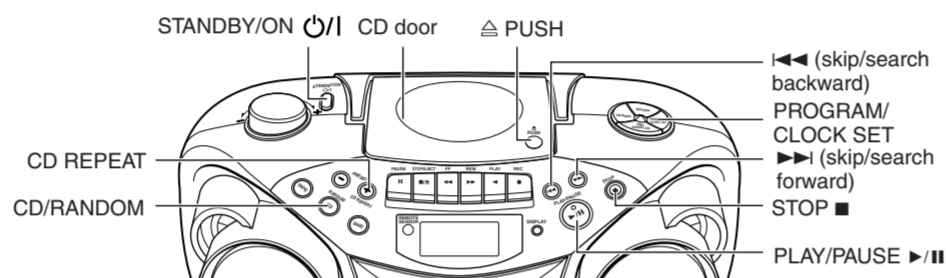

LOADING A CD

1. Press CD/RANDOM; "00 00:00" flashes, then "no disc" appears in the display if no CD is loaded.
2. Press **▲** PUSH to open the CD door.
3. Place a CD into the tray with the label facing up.
4. Close the CD door. Then the total number of tracks and total playing time appear.
5. To remove the CD, press **▲** PUSH, grasp the CD by its edges, and carefully pull it out.

PLAYING A CD

Press PLAY/PAUSE **▶/II** to play all the tracks in order starting with track 1.

The current track number and elapsed playing time appear in the display.

Note: Press PLAY/PAUSE **▶/II** to temporarily stop the CD. The elapsed playing time flashes in the display.

Press PLAY/PAUSE **▶/II** again to resume playing the CD.

- Adjust VOLUME to a comfortable level.
- Press STOP **■** to stop playing the CD. Wait a few seconds for the CD to stop turning, then press **▲** PUSH to open the CD door and remove the CD.

AUTOMATIC SEARCH

Automatic search quickly locates the beginning of any track on the CD, including the track currently playing. If the CD is playing:

- Press **◀◀** once to return to the beginning of the current track, press twice to return to the beginning of the previous track.
- Press **▶▶** to skip to the beginning of the next track.
- If the CD is stopped, repeatedly press **◀◀** or **▶▶** until the display shows the number of the track you want to play, then press PLAY/PAUSE **▶/II**. The CD player starts playing the selected track.

TRACK SEARCH

- In play mode, press and hold **▶▶** to move forward through a track at high speed.
- In play mode, press and hold **◀◀** to move backward through a track at high speed.

REPEAT

The CD REPEAT button repeats one track (REPEAT 1) or all tracks (REPEAT ALL). To scroll through the choices, continuously press and release CD REPEAT, and check the display to see which choice you have selected. The following chart illustrates how REPEAT works in various modes.



RANDOM

In CD mode, press CD/RANDOM. The RANDOM indicator appears in the display and random playback starts.

To quit random playback, press CD/RANDOM again.

PROGRAMMING

1. Press CD/RANDOM to enter CD mode.
2. Press PROGRAM/CLOCK SET in stop mode. The PROG indicator starts blinking in the display window.

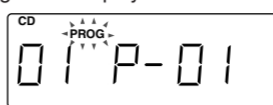

3. Press **◀◀** or **▶▶** to select a desired track to be programmed while the PROG indicator is blinking.

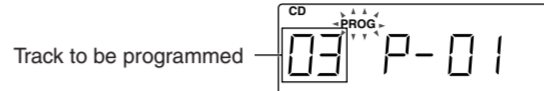

4. Press PROGRAM/CLOCK SET while the PROG indicator is blinking.
5. Repeat steps 3 and 4 to program other tracks.
6. Press PLAY/PAUSE **▶/II** while the PROG indicator is blinking. The tracks are played in the order you have programmed.

Stopping programmed playback

Press STOP **■**. The PROG indicator goes off and the unit exits from programmed playback.

Checking the program contents

Before starting programmed playback, press PROGRAM/CLOCK SET.

Each time you press the button, the programmed tracks are shown in the display window.

Adding tracks in the program

1. Press PROGRAM/CLOCK SET repeatedly until "00" appears as a track number.
2. Press **◀◀** or **▶▶** to select a new track number, then press PROGRAM/CLOCK SET.

Editing the program

1. Press PROGRAM/CLOCK SET repeatedly until the program number you want to edit appears.
2. Press **◀◀** or **▶▶** to select a new track number, then press PROGRAM/CLOCK SET.

Erasing the entire program in the memory

Press PROGRAM/CLOCK SET so that the PROG indicator blinks, and press STOP **■** while the PROG indicator blinks.

The stored program is also cleared when the CD door is opened.

Note:

You can program up to 20 tracks in any desired order. The 21st program will overwrite the program number "01".

INTRO PLAYBACK

Every track or every programmed track of a CD can be played for the beginning ten seconds.

Press INTRO on the remote control unit. The INTRO indicator appears in the display window and intro playback starts. To use intro playback for programmed and random playback, press the button after starting playback.

To quit intro playback, press INTRO again.

CARE AND MAINTENANCE

CLEANING THE EXTERIOR

- Disconnect the system from AC power before cleaning the exterior of the unit with a soft dry cloth.

HANDLING DISCS

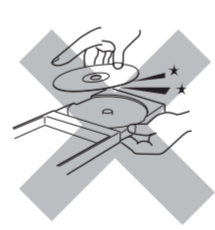

- Remove the disc from its case by holding it at the edge while pressing the center hole lightly.
- Do not touch the shiny surface of the disc, or bend the disc.
- Put the disc back in its case after use to prevent warping.

- Be careful not to scratch the surface of the disc when placing it back in its case.
- Avoid exposure to direct sunlight, temperature extremes, and moisture.

To clean the disc

- Wipe the disc with a soft cloth in a straight line from center to edge.
- DO NOT use any solvent-such as conventional record cleaner, spray, thinner, or benzene-to clean the disc.

HANDLING CASSETTE TAPES



- If the tape is loose in its cassette, take up the slack by inserting a pencil in one of the reels and rotating.
- If the tape is loose, it may get stretched, cut, or caught in the cassette.

- Be careful not to touch the tape surface.

- Avoid storing tapes in any of the following places:
 - In dusty places
 - In direct sunlight or heat
 - In moist areas
 - On a TV or speaker
 - Near a magnet

CLEANING THE TAPE HEADS

Clean the heads after every 10 hours of use with a wet-type head cleaning tape (available at electronic and audio shops).

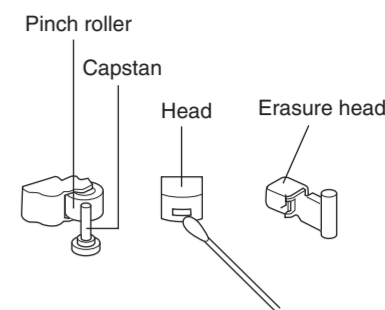

To demagnetize the head

Turn off the unit, and use a head demagnetizer (available at electronic and audio shops).

TROUBLESHOOTING TIPS

Problem	Solution
System does not turn on.	<ul style="list-style-type: none"> • Make sure the power cord is securely plugged into the AC power outlet (or that the batteries are fresh). • Unplug the unit for a moment, and then plug it back in again. • Check the outlet by plugging in another device.
No sound	<ul style="list-style-type: none"> • Adjust the volume setting. • Make sure you have selected the correct function: CD, TAPE, or TUNER and the headphones are disconnected.
Poor radio reception	<ul style="list-style-type: none"> • Adjust the FM telescopic antenna for better FM reception. • Rotate the unit to achieve better AM reception. • Try turning off electrical appliances near the unit, such as TV, hair dryers, vacuum cleaners, or fluorescent lights.
CD does not play.	<ul style="list-style-type: none"> • Make sure the tray contains a CD. • Make sure the CD's label is facing up. • Make sure that pause mode is not activated. • Make sure the CD function is selected.
CD sound skips.	<ul style="list-style-type: none"> • Clean the CD (as explained in "CARE AND MAINTENANCE"). • Check the CD for warping, scratches, or other damage. • Check for vibration or shock that may affect the unit; move system if necessary.
Distorted or noisy recordings	<ul style="list-style-type: none"> • Inspect the recording head and clean it if necessary. • Demagnetize recording head (as explained in "CARE AND MAINTENANCE").

Resetting the unit

If "TROUBLESHOOTING TIPS" does not eliminate malfunctioning (failure to operate or display properly, etc.), press the RESET button on the rear of the unit with something having a sharp point, while the unit is turned on.

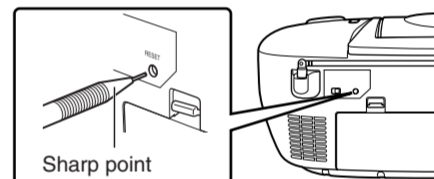

Note:

Resetting causes the unit to restore its factory default settings and results in all the settings made by the user being deleted.

SPECIFICATIONS

CD player

CD capacity	: 1 CD
Dynamic range	: 60 dB
Signal-to-noise ratio	: 75 dB

Tuner

Frequency ranges	: FM 87.5 - 108.0 MHz
	: AM 530 - 1 710 kHz
Antenna	: Telescopic antenna for FM
	: Ferrite core antenna for AM

Cassette deck section

Frequency response	: 60 Hz - 10 000 Hz
Wow and flutter	: 0.15% (WRMS)

General

Speaker	: 9 cm (3.5") cone × 2 (4 Ω)
Power output	: 2 W per channel, min. RMS, driven into 4Ω at 1 kHz with no more than 10 % total harmonic distortion
Output terminals	: PHONES × 1 (∅ 3.5 mm, stereo)
Power supply	: AC 120 V ~, 60 Hz
	: DC 9 V ("R20 (SUM-1)/D (13D)" × 6)
Power consumption	: 13 W (at operation), 3 W (on standby)
Dimensions	: 420 mm (W) × 178 mm (H) × 249 mm (D)
	: (16 9/16 in × 7 1/16 in × 9 13/16 in)
Mass	: Approx. 3.2 kg (7.1 lbs) (without batteries)
Accessories provided	: AC power cord × 1
	: Remote control unit × 1

Design and specifications are subject to change without notice.